

Spartan

SPARTAN



Easily display a graphic or message with this versatile and easy-to-assemble sign stand. The Spartan is a sleek, sign holder featuring a silver aluminum alloy post and black circular base. Add additional posts to hold a larger rigid graphic.



features and benefits:

- Sleek, sign holder features acrylic pocket to hold 8.5" x 11" literature
- Single or double-sided
- Silver aluminum post and black circular base
- Easy to assemble
- Add additional units without the acrylic holder to expand graphic size capabilities with large rigid substrates
- Add second post to hold a larger rigid graphic
- One year limited hardware warranty against manufacturer defects

dimensions:

Hardware	Graphic
<p>Assembled unit: 1 silver aluminum post: 13" w x 52.75" h x 13" d 330 mm(w) x 1340mm(h) x 330mm(d)</p> <p>Weight (without graphic): 6 lbs / 3 kgs</p>	<p>Refer to related graphic template for more information.</p> <p>Visit: www.exhibitors-handbook.com/graphic-templates</p> <p>Two Graphic Applications:</p> <ul style="list-style-type: none"> • Use provided acrylic pocket with a printed 8.5" x 11" sheet of paper. • Use rigid substrate up to 1/8" thick Maximum size will depend on rigidity and weight of the substrate.
<p>Shipping</p> <p>Shipping dimensions (hardware only): 15" l x 14" h x 2" d 381mm(l) x 356mm(h) x 51mm(d)</p> <p>Shipping weight (hardware only): 7 lbs / 4 kgs</p>	<p>Additional Information:</p> <p>Hardware footprint: 13" dia. 330mm(dia).</p>
<p>*Shipping weights and dimensions with graphic vary depending on the quantity of product ordered. Contact your dealer for your specific weights and dimensions.</p>	<p></p> <p>1 person assembly recommended:</p> <p></p>

We are continually improving and modifying our product range and reserve the right to vary the specifications without prior notice. All dimensions and weights quoted are approximate and we accept no responsibility for variance. E&OE. See Graphic Templates for graphic bleed specifications.

Included In Your Kit

Tools, Components,
& Connectors



5MM-ALLEN-T x1



POLE x3

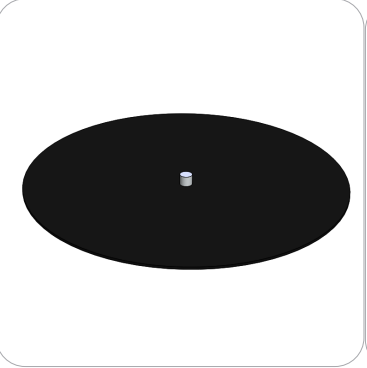

BASE x1



SIGN HOLDER x1

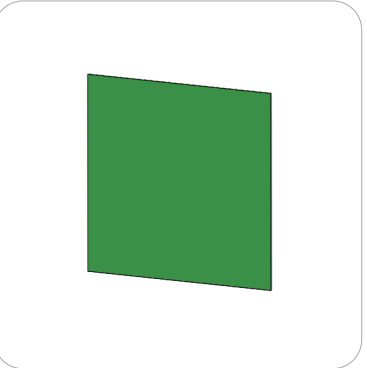

ACRYLIC POCKET

Kit Assembly

Step by Step

Step 1.

Begin by connecting the three poles to form one long pole. Twist to tighten.

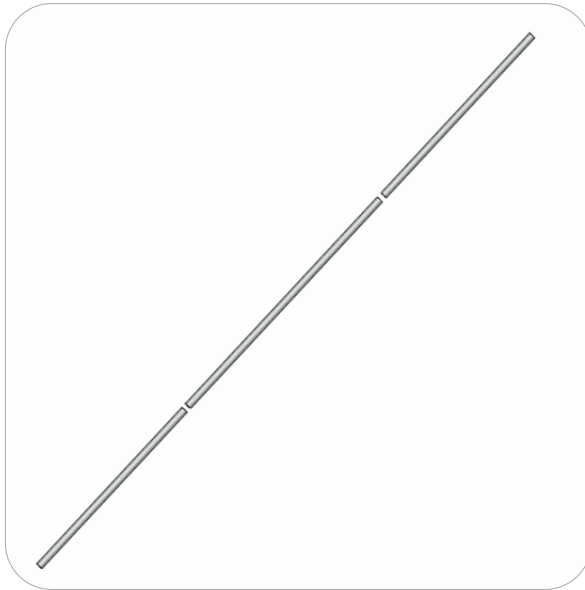

Step 2.

Twist the sign holder to the top of the pole. Twist the pole assembly into the base. Be sure to make all connections tight and secure.

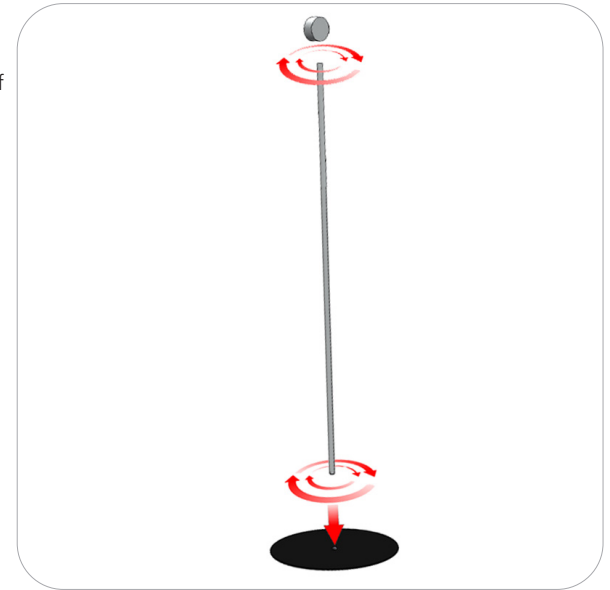

Step 3.

Use your 5MM-ALLEN-T to unlock the sign holder. Place your graphic between the slot of the sign holder. Lock the sign into place by locking the allen head screw.

*Do not over tighten if using acrylic graphic.

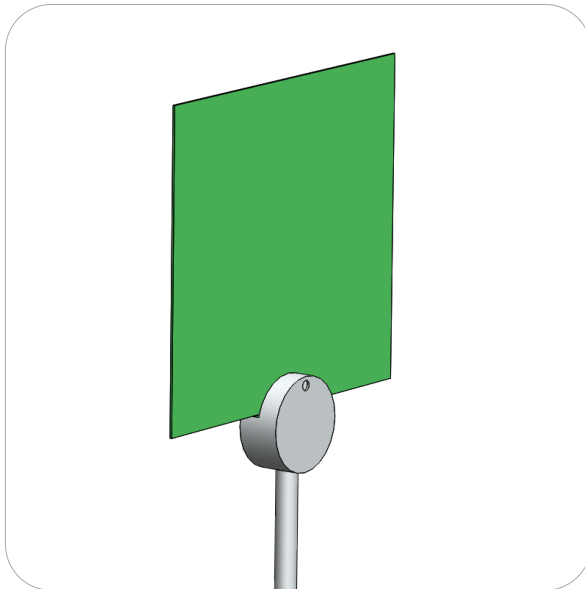

Step 4.

Add additional posts if using large rigid substrates.

